

THE WORLD OF LAPP

EPIC® Industrial connectors – simply complete



Legend for icons

INDUSTRIES



Mechanical and
Plant Engineering



Solar Energy

PRODUCT CHARACTERISTICS



Mechanical resistance



Quantity



Assembly time



Optimum strain relief



Robust



Connector with
standard housing unit



Interference signals



UV-resistant



Waterproof



Info

- Complete connectors - easy to order starting from 1 piece



= Complete connection

Plug

Socket

Please note: the purpose of the icons is to provide you with a quick overview and a rough indication of the product features to which the corresponding information relates. You can find details of product characteristics in the “technical data” sections on the product pages.

content



..... Company information..... 2



..... EPIC® Industrial connectors 6



..... EPIC® Rectangular connectors 8



..... EPIC® Circular connectors 22



..... EPIC® SOLAR connectors 27



..... EPIC® Housings and inserts..... 28



Andreas Lapp,
Matthias Lapp,
Ursula Ida Lapp,
Alexander Lapp,
Siegbert Lapp.

family

On course for success



Family business and global player

LAPP is both. The history of our company has been one of success and expansion ever since it was founded in 1959 by Ursula Ida and Oskar Lapp. It remains resolutely family owned to this day. We safeguard our success by staying close to our customers and markets, maintaining our innovative strength and brand quality, and being a reliable partner. We provide continuity, always guided in our thoughts and actions by our values.

Success built on family values

At LAPP, we maintain values that promote cooperation and enable relationships with employees, suppliers and customers based on partnership and trust. Good relations and mutual respect are key elements of our company culture and a central plank of company policy. We know that our successful business development of the last decades is down in particular to our 3,770 skilled and dedicated staff around the world, as well as the reliable partnership with our customers.

With 17 production facilities, over 40 sales companies and hundreds of dedicated consultants, we are always close to the individual needs and challenges of our customers all over the globe. We are constantly developing our products and system solutions, setting standards in safety, quality and functionality. This is why we are one of the world's leading manufacturers of integrated solutions and branded products in cable and connection technology. As our success story enters its third generation, we are aware of our duty to the future.



www.lappkabel.com/company



EPIC®

[for when things get extreme]

EPIC® for the longest railway tunnel in the world

In June 2016, after more than 20 years of construction, the Gotthard Base Tunnel in Switzerland, which will be the longest railway tunnel in the world at 57 kilometres, is set to have its grand opening. What hardly anyone knows is that EPIC® industrial connectors from LAPP have also contributed to the success of this construction of the century. In order to dig the two railway tunnels from north to south through the hard rock, four tunnel boring machines from the tunnel

construction experts Herrenknecht based in Schwanau (Baden-Württemberg, Germany) were used. Just one machine (the so-called Gripper TBM) has over 26 tons of pressing force, is 400 metres long and 9 metres wide. This makes it possible to break down even the hardest stone. EPIC® connectors were used here as extension connectors, since the further the tunnel boring machine is driven into the mountain the longer the cable for the power supply and controls

must be. The EPIC® H-BE connectors were interconnected with housings and inserts every 50 metres to ensure that everything works reliably. These connectors are particularly suitable for higher voltages and currents and boast a high level of reliability. This is particularly important deep in the tunnel. Incidentally: the new tunnel will shorten the travel time for trains running between Zurich and Milan by an hour to just 2 hours and 40 minutes.

EPIC® connectors also help to supply power to the tunnel boring machines from Herrenknecht in the Gotthard Base Tunnel



Finding solutions

EPIC® Connector Selector – Support for configuration of Industrial Connectors

Design, insert, housing and counterpart. These four selections take you to the appropriate connector in just a few clicks.

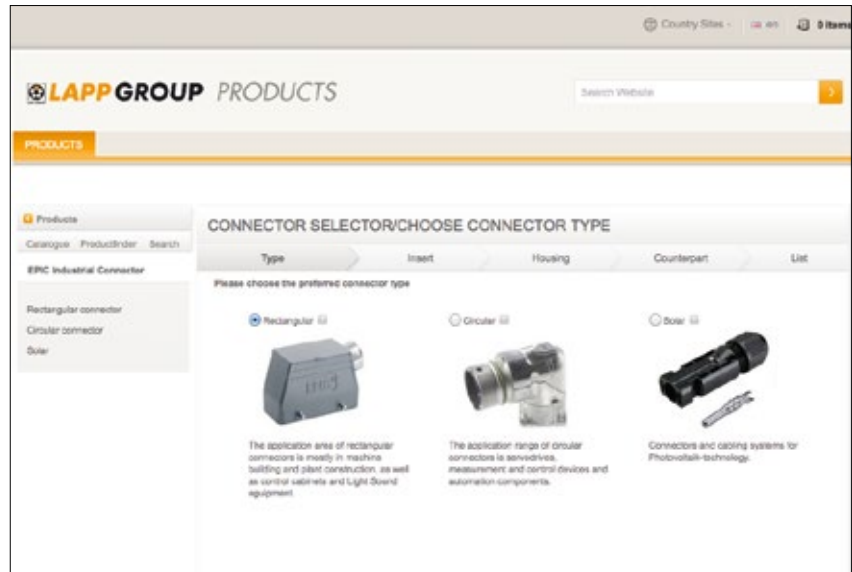

<http://products.lappgroup.com/connectorselector.html>

Cable Connector Selector

Configure your own individual industrial connector housing with locking concept and cable entries.

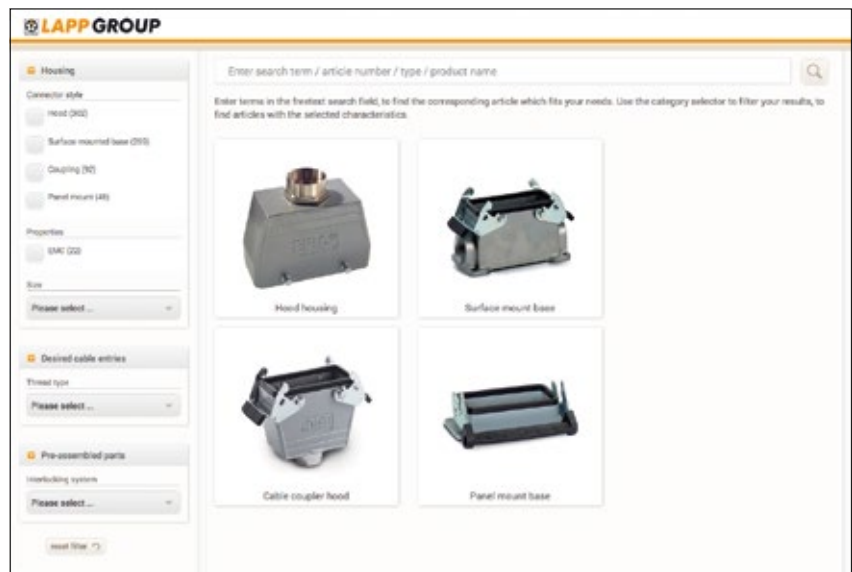

<http://products.lappgroup.com/connector-housing.html>

EPIC® Industrial connectors

At a glance

Properties 	Connection type					Connection cross section in mm ² depending on connection type	Rated voltage according to standards			Rated current for largest connection cross section according to standards			Approvals International
	Screw	Crimp	Spring	Push-In	Solder		IEC	UL/USR	CSA/CNR	IEC	UL/USR	CSA/CNR	
Rectangular – inserts fixed													
EPIC® H-A 3, 4	●					0.5 – 2.5	400 V	600 V	600 V	23 A	10 A	10 A	VDE, UR, CSA
EPIC® H-A 10, 16, 32, 48	●					0.5 – 2.5	250 V	600 V	600 V	16 A	14 A	16 A	VDE, UR, CSA
EPIC® STA 6, 14, 20	●				●	0.5 – 1.5/ max. 1.5	24 VAC/60 VDC	48 V	48 V	10 A	10 A	10 A	UR, CSA
EPIC® H-Q 5		●				0.14 – 4.0	230 V/400 V	600 V	600 V	16 A	16 A	16 A	UR, CSA
EPIC® H-D 7, 8		●				0.14 – 2.5	H*	250 V	–	10 A	10 A	–	UR
EPIC® H-D 15, 25, 40, 64		●				0.14 – 2.5	250 V	250 V	–	10 A	10 A	–	UR
EPIC® H-DD 24, 42, 72, 108		●				0.14 – 2.5	250 V	600 V	600 V	10 A	8.5 A	10 A	UR, CSA
EPIC® H-BE 6, 10, 16, 24, 32, 48	●	●	●	●		0.5 – 2.5/ 0.14 – 4.0	500 V	600 V	600 V	16 A	16 A	16 A	VDE, cURus
EPIC® H-EE 10, 18, 32, 46		●				0.14 – 4.0	500 V	600 V	600 V	16 A	16 A	16 A	UR, CSA
EPIC® H-BS 6, 12	●					0.5 – 6.0	500 V	600 V	600 V	35 A	35 A	35 A	UR, CSA
EPIC® H-BVE 3, 6, 10	●					0.5 – 2.5	630 V	600 V	600 V	16 A	16 A	16 A	VDE, cURus
POWER H-S 4	●					2.5 – 10.0	1000 V	–	–	65 A	–	–	–
EPIC® POWER K 4/0, 4/2	●					1.5 – 16.0	830 V	–	–	80 A	–	–	–
EPIC® TB-H-BE 16, 24	●					0.5 – 4.0	500 V	600 V	600 V	16 A	16 A	16 A	UR, CSA
Rectangular – inserts modular													
High voltage 1+PE, 2	●					10.0 – 25.0	1000 V	600 V	–	82 A	82 A	–	VDE, cURus
EPIC® POWER HC2		●				16	1000 V	–	–	65 A	–	–	–
POWER HHC2		●				16.0 – 35.0	1000 V	–	–	150 A	–	–	–
POWER HHC1		●				50.0 – 95.0	1000 V	–	–	220 A	–	–	–
High voltage 3-pin		●				1.5 – 10.0	1000 V	–	–	50 A	–	–	–
High voltage 4+PE		●				0.5 – 2.5	1000 V	–	–	16 A	–	–	–
3-pin		●				1.5 – 10.0	630 V	600 V	600 V	40 A	40 A	35 A	UR, CSA
HE 4-pin		●				0.5 – 4.0	630 V	–	–	25 A	–	–	–
Cage clamp 4-pin			●			0.5 – 2.5	400 V	–	–	14 A	–	–	–
5-pin		●				0.5 – 4.0	400 V	400 V	400 V	20 A	20 A	16 A	UR, CSA
10-pin		●				0.14 – 2.5	250 V	250 V	240 V	10 A	10 A	10 A	UR, CSA
10-pin stamped		●				0.14 – 2.5	250 V	–	–	10 A	–	–	–
20-pin		●				0.08 – 0.56	100 V	100 V	100 V	4 A	4 A	4 A	UR, CSA
Blind						–	–	–	–	–	–	–	–
Coaxial		●				Coaxial	250 V	–	–	–	–	–	–
PROFIBUS® DP	●					0.08 – 1.5	30 V	–	–	1 A	–	–	–
Universal bus	●					0.08 – 1.5	30 V	–	–	1 A	–	–	–
RJ45		●				0.14 – 2.5/ 0.12 – 0.2	600 V/ 125 V	–	–	P: 10 A S: 1.5 A	–	–	–
Pneumatic 1, 2-pin				●		∅ 2.5/4.0 mm ∅ 2.5/4.0 mm	–	–	–	–	–	–	–
Round													
EPIC® POWER M12 3+PE	●					0.75 – 1.5	630 V	600 V	–	12 A	12 A	12 A	cURus
EPIC® SIGNAL M17 8, 17		●				0.06 – 0.56/ 0.06 – 1.0	60 V	–	–	3.6 A	–	–	–
EPIC® POWER M17 3+PE		●				0.5 – 2.5	630 V	–	–	20 A	–	–	–
EPIC® POWER M17 5+PE, 6+PE, 7+PE		●				0.06 – 1.0	630 V	–	–	14 A	–	–	–
EPIC® POWER M17 3+PE+5		●				0.06 – 1.0/ 0.06 – 0.56	630 V/ 60 V	–	–	P: 14 A S: 3.6 A	–	–	–
EPIC® SIGNAL M23 6, 7		●			●	0.06 – 2.5	150 V	150 V	150 V	18 A	15 A	15 A	VDE, cURus
EPIC® SIGNAL M23 8+1		●			●	0.06 – 1.0/ 0.06 – 2.5	150 V	150 V	150 V	P: 20 A S: 7 A	P: 20 A S: 7 A	P: 20 A S: 7 A	VDE, cURus
EPIC® SIGNAL M23 9		●			●	0.06 – 1.0	150 V	150 V	150 V	7 A	7 A	6 A	VDE, cURus
EPIC® SIGNAL M23 12, 16		●			●	0.06 – 1.0	100 V	100 V	100 V	7 A	7 A	6 A	VDE, cURus
EPIC® SIGNAL M23 17		●			●	0.06 – 1.0	50 V	50 V	50 V	7 A	7 A	7 A	VDE, cURus
EPIC® SIGNAL R3.0					●	0.06 – 1.0	24 VAC/60 VDC	–	–	7.5 A	–	–	–
EPIC® POWER LS1 5+PE		●				0.5 – 4.0	630 V	600 V	600 V	25 A	22 A	17 A	VDE, cURus
EPIC® POWER LS1 3+PE+4		●				0.5 – 4.0/ 0.4 – 1.0	630 V/250 V	600 V/ 250 V	600 V/ 250 V	P: 26 A S: 7 A	P: 22 A S: 7 A	P: 17 A S: 7 A	VDE, cURus
EPIC® POWER LS1.5 3+PE+2, 3+PE+4		●				0.75 – 10.0/ 0.14 – 4.0	630 V/250 V	–	–	P: 70 A S: 30 A	–	–	–
EPIC® POWER LS3 3+PE+2, 3+PE+4		●				10.0 – 50.0/ 0.75 – 1.5	630 V/250 V	–	–	P: 150 A S: 12 A	–	–	–
EPIC® POWERLOCK S	●					50.0 – 120.0	1000 V	–	–	400 A	–	–	VDE
EPIC® POWERLOCK C	●					35.0 – 240.0	1000 V	–	–	660 A	–	–	VDE
SOLAR													
EPIC® SOLAR 4	●					2.5 – 6.0	1000 V	–	–	30 A	–	–	TÜV

P: Power S: Signal H*: In metal housing; 24 VAC/60 VDC; in plastic housing; 250 V

EPIC® rectangular connectors

Flexible, robust connectors for mechanical engineering



The connector system for mechanical and plant engineering and wherever a robust connection system is required. EPIC® Rectangular connectors are available as components. The right connector for any application can be made individually from housings, inserts and contacts.

www.lappgroup.com/connectorfinder

For the housing, there are two performance classes to choose from

- EPIC® Standard is robust and there is a flexible choice of cable entries www.lappgroup.com/connector-housing
- EPIC® ULTRA has a high corrosion protection, EMC protection as well as a stainless steel interlocking device

EPIC® inserts are available in a fixed pin design and as a modular system

- EPIC® fixed pin inserts are easy to handle and come in a wide variety of designs
- EPIC® modular inserts offer flexibility with modules for data, signals, power, fibre-optics and pneumatics. This means every insert is individually tailor-made for the relevant modul configuration

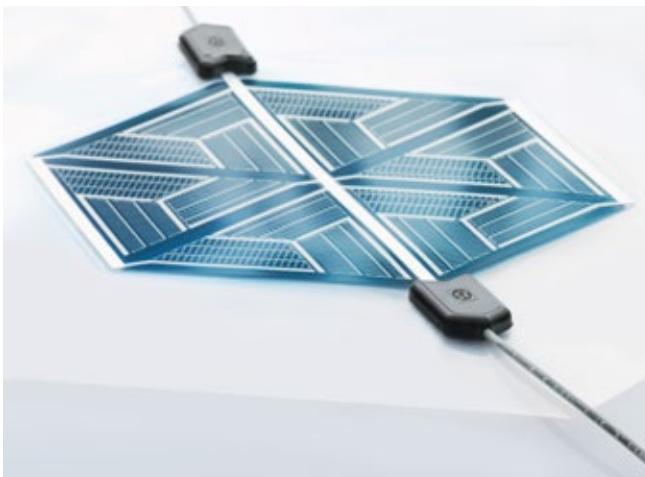

Photographs are not to scale and do not represent detailed images of the respective products.

EPIC® circular connectors

Compact connectors for motion control and energy transfer



Circular connections come in two designs, a signal design with gold-plated contacts for transmitting delicate signals and as high-reserve power connectors.

EPIC® SIGNAL connectors are available as M17, M23 and R3.0 (M27)

- The metal housing with an integrated EMC screen contact reliably prevents electromagnetic interferences
- Gold-plated signal contacts reliably transmit with the lowest of currents and voltages

EPIC® POWER connectors are available as M12, M17, LS1 (M23), LS1.5 (M40) and LS3 (M58)

- The integrated EMC cable glands offer strain relief and are perfectly sealed
- High-quality sealing materials for good chemical protection

EPIC® POWERLOCK

- Perfect for transmitting very high currents
- Colour coded and geometrically coded in order to prevent incorrect connections

EPIC® SOLAR connectors

Durable connectors for photovoltaics

High-quality connections for a long-term and reliable outdoor connection

EPIC® SOLAR field harnessable

- Crimp and insert the contact, twist the cable gland, it's that simple

EPIC® SOLAR Map for organic PV modules

- Customised production instead of off-the-shelf products, that's what the new PV connection technology made by LAPP is about



EPIC® ULTRA KIT H-B 6

Benefits

- EMC protection
- Corrosion-resistant
- Push-In inserts – fast and easy tool free connection technology

Technical data

	Rated voltage (V) IEC: 500 V UL: 600 V CSA: 600 V
	Rated current (A) IEC: 16 A UL: 13 A CSA: 13 A
	Number of contacts 6 + PE

Info

- Complete connectors – easy to order



Article number	Pieces/PU
75009734	1

Article numbers for single components

- 70250202
- 44423200

EPIC ULTRA Kit H-B 6 SP TG LB 9-17



- Male insert EPIC® H-BE 6 Push-In termination
- EMC hood EPIC® ULTRA H-B 6
- Integrated SKINTOP® cable gland



Article number	Pieces/PU
75009735	1

Article numbers for single components

- 70250205
- 44423200

EPIC ULTRA Kit H-B 6 SP TS LB 9-17



- Male insert EPIC® H-BE 6 Push-In termination
- EMC hood EPIC® ULTRA H-B 6
- Integrated SKINTOP® cable gland



Article number	Pieces/PU
75009736	1

Article numbers for single components

- 70250206
- 44423201

EPIC ULTRA Kit H-B 6 BP AG LB



- Female insert EPIC® H-BE 6 Push-In termination
- EMC panel-mount base EPIC® ULTRA H-B 6



Article number	Pieces/PU
75009737	1

Article numbers for single components

- 70250209
- 44423201

EPIC ULTRA Kit H-B 6 BP SGR LB 9-17



- Female insert EPIC® H-BE 6 Push-In termination
- EMC surface-mount base EPIC® ULTRA H-B 6
- Integrated SKINTOP® cable gland



EPIC® ULTRA KIT H-B 10

Benefits

- EMC protection
- Corrosion-resistant
- Push-In inserts – fast and easy tool free connection technology

Technical data

	Rated voltage (V) IEC: 500 V UL: 600 V CSA: 600 V
	Rated current (A) IEC: 16 A UL: 13 A CSA: 13 A
	Number of contacts 10 + PE

Info

- Complete connectors – easy to order

EPIC® ULTRA Kit H-B 10 SP TS QB 11-21



- Male insert EPIC® H-BE 10 Push-In termination
- EMC hood EPIC® ULTRA H-B 10
- Integrated SKINTOP® cable gland

Article number	Pieces/PU
75009738	1

Article numbers for single components

- 70250212
- 44423202



EPIC ULTRA Kit H-B 10 BP AG QB



- Female insert EPIC® H-BE 10 Push-In termination
- EMC panel-mount base EPIC® ULTRA H-B 10

Article number	Pieces/PU
75009739	1

Article numbers for single components

- 70250213
- 44423203





EPIC® ULTRA KIT H-B 16

Benefits

- EMC protection
- Corrosion-resistant
- Push-In inserts – fast and easy tool free connection technology

Technical data

	Rated voltage (V) IEC: 500 V UL: 600 V CSA: 600 V
	Rated current (A) IEC: 16 A UL: 13 A CSA: 13 A
	Number of contacts 16 + PE

Info

- Complete connectors – easy to order



Article number	Pieces/PU
75009740	1

Article numbers for single components

- 70250216
- 44423204

EPIC ULTRA Kit H-B 16 SP TS QB 11-21



- Male insert EPIC® H-BE 16 Push-In termination
- EMC hood EPIC® ULTRA H-B 16
- Integrated SKINTOP® cable gland



Article number	Pieces/PU
75009741	1

Article numbers for single components

- 70250217
- 44423205

EPIC ULTRA Kit H-B 16 BP AG QB



- Female insert EPIC® H-BE 16 Push-In termination
- EMC panel-mount base EPIC® ULTRA H-B 16



EPIC® ULTRA KIT H-B 24

Benefits

- EMC protection
- Corrosion-resistant
- Push-In inserts – fast and easy tool free connection technology

Technical data

	Rated voltage (V) IEC: 500 V UL: 600 V CSA: 600 V
	Rated current (A) IEC: 16 A UL: 13 A CSA: 13 A
	Number of contacts 24 + PE

Info

- Complete connectors – easy to order

EPIC ULTRA Kit H-B 24 SP TS QB 11-21



- Male insert EPIC® H-BE 24 Push-In termination
- EMC hood EPIC® ULTRA H-B 24
- Integrated SKINTOP® cable gland

Article number	Pieces/PU
75009742	1

Article numbers for single components

- 70250221
- 44423206



EPIC ULTRA Kit H-B 24 BP AG QB



- Female insert EPIC® H-BE 24 Push-In termination
- EMC panel mount base EPIC® ULTRA H-B 24

Article number	Pieces/PU
75009743	1

Article numbers for single components

- 70250222
- 44423207





EPIC® H-A 3 Kits Thermoplastic

Benefits

- Pre-packed kits with compatible components
- Uncomplicated ordering
- No misplaced orders

Similar products

- EPIC® H-A 3 Kits Metal

Technical data

	Rated voltage (V) IEC: 400 V UL: 600 V CSA: 600 V
	Rated current (A) IEC: 23 A UL: 10 A CSA: 10 A
	Number of contacts 3 + PE



Info

- Complete connectors - easy to order starting from 1 piece



= Complete connection



Article number	Pieces/PU
EPIC® H-A 3 Kits Thermoplastic	
75009601	1

Article numbers for single components

- H-A 3 SS 10420000
- H-A 3 Tgv M20 19426000

Article number	Pieces/PU
H-A 3 Tgv M20	
75009603	1

Article numbers for single components

- H-A 3 SS 10420000
- H-A 3 Ts M20 19427000

Article number	Pieces/PU
H-A 3 Ts M20	
75009605	1

Article numbers for single components

- H-A 3 BS 10421000
- H-A 3 Ag 10422000

Article number	Pieces/PU
H-A 3 Ag	
75009607	1

Article numbers for single components

- H-A 3 BS 10421000
- H-A 3 Ags 10423000

Article number	Pieces/PU
H-A 3 Ags	
75009609	1

Article numbers for single components

- H-A 3 BS 10421000
- H-A 3 Agsv M20 19421900

Article number	Pieces/PU
H-A 3 Agsv M20	
75009611	1

Article numbers for single components

- H-A 3 BS 10421000
- H-A 3 Tgvb M20 19429000

EPIC KIT H-A 3 SS TG M20



- EPIC® H-A 3 screw-termination male insert
- EPIC® H-A 3 hood
- Housing: thermoplastic grey

EPIC KIT H-A 3 SS TS M20



- EPIC® H-A 3 screw-termination male insert
- EPIC® H-A 3 hood
- Side cable entry
- Housing: thermoplastic grey

EPIC KIT H-A 3 BS AG



- EPIC® H-A 3 screw-termination female insert
- EPIC® H-A 3 panel-mount base
- Straight version
- Housing: thermoplastic grey

EPIC KIT H-A 3 BS AGS



- EPIC® H-A 3 screw-termination female insert
- EPIC® H-A 3 panel-mount base
- Angled version
- Housing: thermoplastic grey

EPIC KIT H-A 3 BS AGS M20



- EPIC® H-A 3 screw-termination female insert
- EPIC® H-A 3 panel-mount base
- Angled version
- Housing: thermoplastic grey

EPIC KIT H-A 3 BS TGB M20



- EPIC® H-A 3 screw-termination female insert
- EPIC® H-A 3 cable coupler hood
- Housing: thermoplastic grey



EPIC® H-A 3 Kits Metal

Benefits

- Pre-packed kits with compatible components
- Uncomplicated ordering
- No misplaced orders

Similar products

- EPIC® H-A 3 Kits Thermoplastic

Technical data

	Rated voltage (V) IEC: 400 V UL: 600 V CSA: 600 V
	Rated current (A) IEC: 23 A UL: 10 A CSA: 10 A
	Number of contacts 3 + PE

Info

- Complete connectors – easy to order starting from 1 piece

+ = Complete connection

EPIC KIT H-A 3 SS MTG M20



- EPIC® H-A 3 screw-termination male insert
- EPIC® H-A 3 hood
- Housing: zinc die-casting, grey

Article number	Pieces/PU
EPIC® H-A 3 Kits Metal	
75009602	1
Article numbers for single components	
• H-A 3 SS 10420000	
• H-A 3 MTgv M20 19512100	



EPIC KIT H-A 3 SS MTS M20



- EPIC® H-A 3 screw-termination male insert
- EPIC® H-A 3 hood
- Side cable entry
- Housing: zinc die-casting, grey

Article number	Pieces/PU
H-A 3 MTgv M20	
75009604	1
Article numbers for single components	
• H-A 3 SS 10420000	
• H-A 3 Ts M20 19512300	



EPIC KIT H-A 3 BS MAG



- EPIC® H-A 3 screw-termination female insert
- EPIC® H-A 3 panel-mount base
- Straight version
- Housing: zinc die-casting, grey

Article number	Pieces/PU
H-A 3 Ts M20	
75009606	1
Article numbers for single components	
• H-A 3 BS 10421000	
• H-A 3 Mag 10422500	



EPIC KIT H-A 3 BS MAGS



- EPIC® H-A 3 screw-termination female insert
- EPIC® H-A 3 panel-mount base
- Angled version
- Housing: zinc die-casting, grey

Article number	Pieces/PU
H-A 3 Mag	
75009608	1
Article numbers for single components	
• H-A 3 BS 10421000	
• H-A 3 Mags 10423500	



EPIC KIT H-A 3 BS MAGS M20



- EPIC® H-A 3 screw-termination female insert
- EPIC® H-A 3 panel-mount base
- Angled version
- Housing: zinc die-casting, grey

Article number	Pieces/PU
H-A 3 Mags	
75009610	1
Article numbers for single components	
• H-A 3 BS 10421000	
• H-A 3 MAgsv M20 19512700	



EPIC KIT H-A 3 BS MTGB M20



- EPIC® H-A 3 screw-termination female insert
- EPIC® H-A 3 cable coupler hood
- Housing: zinc die-casting, grey

Article number	Pieces/PU
H-A 3 MAgsv M20	
75009612	1
Article numbers for single components	
• H-A 3 BS 10421000	
• H-A 3 MTgvb M20 19512900	





EPIC® H-A 4 Kits Thermoplastic

Benefits

- Pre-packed kits with compatible components
- Uncomplicated ordering
- No misplaced orders

Similar products

- EPIC® H-A 4 Kits Metal

Technical data

	Rated voltage (V) IEC: 400 V UL: 600 V CSA: 600 V
	Rated current (A) IEC: 23 A UL: 10 A CSA: 10 A
	Number of contacts 4 + PE

Info

- Complete connectors – easy to order starting from 1 piece

+ = Complete connection



Article number	Pieces/PU
EPIC® H-A 4 Kits Thermoplastic	
75009613	1

Article numbers for single components

- H-A 4 SS 10431000
- H-A 3 Tgv M20 19426000

Article number	Pieces/PU
H-A 3 Tgv M20	
75009615	1

Article numbers for single components

- H-A 4 SS 10431000
- H-A 3 Ts M20 19427000

Article number	Pieces/PU
H-A 3 Ts M20	
75009617	1

Article numbers for single components

- H-A 4 BS 10432000
- H-A 3 Ag 10422000

Article number	Pieces/PU
H-A 3 Ag	
75009619	1

Article numbers for single components

- H-A 4 BS 10432000
- H-A 3 Ags 10423000

Article number	Pieces/PU
H-A 3 Ags	
75009621	1

Article numbers for single components

- H-A 4 BS 10432000
- H-A 3 Agsv M20 19421900

Article number	Pieces/PU
H-A 3 Agsv M20	
75009623	1

Article numbers for single components

- H-A 4 BS 10432000
- H-A 3 Tgvb M20 19429000

EPIC KIT H-A 4 SS TG M20



- EPIC® H-A 4 screw-termination male insert
- EPIC® H-A 3 hood
- Straight cable entry
- Housing: thermoplastic grey

EPIC KIT H-A 4 SS TS M20



- EPIC® H-A 4 screw-termination male insert
- EPIC® H-A 3 hood
- Side cable entry
- Housing: thermoplastic grey

EPIC KIT H-A 4 BS AG



- EPIC® H-A 4 screw-termination female insert
- EPIC® H-A 3 panel-mount base
- Straight version
- Housing: thermoplastic grey

EPIC KIT H-A 4 BS AGS



- EPIC® H-A 4 screw-termination female insert
- EPIC® H-A 3 panel-mount base
- Angled version
- Housing: thermoplastic grey

EPIC KIT H-A 4 BS AGS M20



- EPIC® H-A 4 screw-termination female insert
- EPIC® H-A 3 panel-mount base
- Angled version
- Housing: thermoplastic grey

EPIC KIT H-A 4 BS TGB M20



- EPIC® H-A 4 screw-termination female insert
- EPIC® H-A 3 cable coupler hood
- Straight cable entry
- Housing: thermoplastic grey



EPIC® H-A 4 Kits Metal

Benefits

- Pre-packed kits with compatible components
- Uncomplicated ordering
- No misplaced orders

Similar products

- EPIC® H-A 4 Kits Thermoplastic

Technical data

	Rated voltage (V) IEC: 400 V UL: 600 V CSA: 600 V
	Rated current (A) IEC: 23 A UL: 10 A CSA: 10 A
	Number of contacts 4 + PE

Info

- Complete connectors – easy to order starting from 1 piece

+ = Complete connection

EPIC KIT H-A 4 SS MTG M20



- EPIC® H-A 4 screw-termination male insert
- EPIC® H-A 3 hood
- Straight cable entry
- Housing: zinc die-casting, grey

Article number	Pieces/PU
EPIC® H-A 4 Kits Metal	
75009614	1

Article numbers for single components

- H-A 4 SS 10431000
- H-A 3 MTgv M20 19512100



EPIC KIT H-A 4 SS MTS M20



- EPIC® H-A 4 screw-termination male insert
- EPIC® H-A 3 hood
- Side cable entry
- Housing: zinc die-casting, grey

Article number	Pieces/PU
H-A 3 MTgv M20	
75009616	1

Article numbers for single components

- H-A 4 SS 10431000
- H-A 3 Ts M20 19512300



EPIC KIT H-A 4 BS MAG



- EPIC® H-A 4 screw-termination female insert
- EPIC® H-A 3 panel-mount base
- Straight version
- Housing: zinc die-casting, grey

Article number	Pieces/PU
H-A 3 Ts M20	
75009618	1

Article numbers for single components

- H-A 4 BS 10432000
- H-A 3 Mag 10422500



EPIC KIT H-A 4 BS MAGS



- EPIC® H-A 4 screw-termination female insert
- EPIC® H-A 3 panel-mount base
- Angled version
- Housing: zinc die-casting, grey

Article number	Pieces/PU
H-A 3 Mag	
75009620	1

Article numbers for single components

- H-A 4 BS 10432000
- H-A 3 Mags 10423500



EPIC KIT H-A 4 BS MAGS M20



- EPIC® H-A 4 screw-termination female insert
- EPIC® H-A 3 panel-mount base
- Angled version
- Housing: zinc die-casting, grey

Article number	Pieces/PU
H-A 3 Mags	
75009622	1

Article numbers for single components

- H-A 4 BS 10432000
- H-A 3 MAGsv M20 19512700



EPIC KIT H-A 4 BS TGB M20



- EPIC® H-A 4 screw-termination female insert
- EPIC® H-A 3 cable coupler hood
- Straight cable entry
- Housing: zinc die-casting, grey

Article number	Pieces/PU
H-A 3 MAGsv M20	
75009624	1

Article numbers for single components

- H-A 4 BS 10432000
- H-A 3 MTgvb M20 19512900





EPIC® H-A 10 Kits

Benefits

- Pre-packed kits with compatible components
- Uncomplicated ordering
- No misplaced orders

Technical data

	Rated voltage (V) IEC: 250 V UL: 600 V CSA: 600 V
	Rated current (A) IEC: 16 A UL: 14 A CSA: 16 A
	Number of contacts 10 + PE

Info

- Complete connectors – easy to order starting from 1 piece

+ = Complete connection



Article number	Pieces/PU
EPIC® H-A 10 Kits	
75009625	1
Article numbers for single components	
• H-A 10 SS 10440100	
• H-A 10 TG M20 19446000	

EPIC KIT H-A 10 SS TG M20



- EPIC® H-A 10 screw-termination male insert
- With wire protection
- EPIC® H-A 10 hood



Article number	Pieces/PU
H-A 10 TG M20	
75009626	1
Article numbers for single components	
• H-A 10 SS 10440100	
• H-A 10 TS M20 19445000	

EPIC KIT H-A 10 SS TS M20



- EPIC® H-A 10 screw-termination male insert
- With wire protection
- EPIC® H-A 10 hood



Article number	Pieces/PU
H-A 10 TS M20	
75009627	1
Article numbers for single components	
• H-A 10 BS 10441100	
• H-A 10 AG-LB 10442000	

EPIC KIT H-A 10 BS AG



- EPIC® H-A 10 screw-termination female insert
- With wire protection
- EPIC® H-A 10 panel-mount base



Article number	Pieces/PU
H-A 10 AG-LB	
75009628	1
Article numbers for single components	
• H-A 10 BS 10441100	
• H-A 10 SGR-LB M20 19448100	

EPIC KIT H-A 10 BS SGR-LB M20



- EPIC® H-A 10 screw-termination female insert
- With wire protection
- EPIC® H-A 10 surface-mount base



Article number	Pieces/PU
H-A 10 SGR-LB M20	
75009629	1
Article numbers for single components	
• H-A 10 BS 10441100	
• H-A 10 TBF-LB M20 19439000	

EPIC KIT H-A 10 BS TBF-LB M20



- EPIC® H-A 10 screw-termination female insert
- With wire protection
- EPIC® H-A 10 cable coupler hood



EPIC® H-A 16 Kits

Benefits

- Pre-packed kits with compatible components
- Uncomplicated ordering
- No misplaced orders

Technical data

	Rated voltage (V) IEC: 250 V UL: 600 V CSA: 600 V
	Rated current (A) IEC: 16 A UL: 14 A CSA: 16 A
	Number of contacts 16 + PE

Info

- Complete connectors – easy to order starting from 1 piece

+ = Complete connection

EPIC KIT H-A 16 SS TG M20



- EPIC® H-A 16 screw-termination male insert
- With wire protection
- EPIC® H-A 16 hood

Article number	Pieces/PU
EPIC® H-A 16 Kits	
75009630	1
Article numbers for single components	
• H-A 16 SS 10530000	
• H-A 16 TG M20 19565000	



EPIC KIT H-A 16 SS TS M20



- EPIC® H-A 16 screw-termination male insert
- With wire protection
- EPIC® H-A 16 hood

Article number	Pieces/PU
H-A 16 TG M20	
75009631	1
Article numbers for single components	
• H-A 16 SS 10530000	
• H-A 16 TS M20 19564000	



EPIC KIT H-A 16 BS AG



- EPIC® H-A 16 screw termination female insert
- With wire protection
- EPIC® H-A 16 panel-mount base

Article number	Pieces/PU
H-A 16 TS M20	
75009632	1
Article numbers for single components	
• H-A 16 BS 10531000	
• H-A 16 AG-LB 10462000	



EPIC KIT H-A 16 BS SGR-LB M20



- EPIC® H-A 16 screw termination female insert
- With wire protection
- EPIC® H-A 16 surface-mount base

Article number	Pieces/PU
H-A 16 AG-LB	
75009633	1
Article numbers for single components	
• H-A 16 BS 10531000	
• H-A 16 SGR-LB M20 19567100	



EPIC KIT H-A 16 BS TBF-LB M20



- EPIC® H-A 16 screw termination female insert
- With wire protection
- EPIC® H-A 16 cable coupler hood

Article number	Pieces/PU
H-A 16 SGR-LB M20	
75009634	1
Article numbers for single components	
• H-A 16 BS 10531000	
• H-A 16 TBF-LB M20 19563000	





EPIC® H-BE 6 Kits

Benefits

- Pre-packed kits with compatible components
- Uncomplicated ordering
- No misplaced orders

Technical data

	Rated voltage (V) IEC: 500 V UL: 600 V CSA: 600 V
	Rated current (A) IEC: 16 A UL: 16 A CSA: 16 A
	Number of contacts 6 + PE

Info

- Complete connectors - easy to order starting from 1 piece

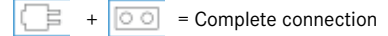

Article number	Pieces/PU
EPIC® H-BE 6 Kits	
75009635	1
Article numbers for single components	
• EPIC® H-BE 6 SS 10190000	
• H-B 6 TG M20 19011000	

EPIC® KIT H-BE 6 SS TG M20



- EPIC® H-BE 6 screw-termination male insert
- With wire protection
- EPIC® H-B 6 hood



Article number	Pieces/PU
H-B 6 TG M20	
75009636	1
Article numbers for single components	
• EPIC® H-BE 6 SS 10190000	
• H-B 6 TS M20 19012000	

EPIC® KIT H-BE 6 SS TS M20



- EPIC® H-BE 6 screw-termination male insert
- With wire protection
- EPIC® H-B 6 hood



Article number	Pieces/PU
H-B 6 TS M20	
75009637	1
Article numbers for single components	
• EPIC® H-BE 6 BS 10191000	
• H-B 6 AG-LB 10003000	

EPIC® KIT H-BE 6 BS AG-LB



- EPIC® H-BE 6 screw-termination female insert
- With wire protection
- EPIC® H-B 6 panel-mount base



Article number	Pieces/PU
H-B 6 AG-LB	
75009638	1
Article numbers for single components	
• EPIC® H-BE 6 BS 10191000	
• H-B 6 SGR M20 19005000	

EPIC® KIT H-BE 6 BS SGR-LB M20



- EPIC® H-BE 6 screw-termination female insert
- With wire protection
- EPIC® H-B 6 surface-mount base



Article number	Pieces/PU
H-B 6 SGR M20	
75009639	1
Article numbers for single components	
• EPIC® H-BE 6 BS 10191000	
• H-B 6 TBF M20 19014000	

EPIC® KIT H-BE 6 BS TBF-LB M20



- EPIC® H-BE 6 screw-termination female insert
- With wire protection
- EPIC® H-B 6 cable coupler hood



EPIC® H-BE 10 Kits

Benefits

- Pre-packed kits with compatible components
- Uncomplicated ordering
- No misplaced orders

Technical data

	Rated voltage (V) IEC: 500 V UL: 600 V CSA: 600 V
	Rated current (A) IEC: 16 A UL: 16 A CSA: 16 A
	Number of contacts 10 + PE

Info

- Complete connectors - easy to order starting from 1 piece

+ = Complete connection

EPIC® KIT H-BE 10 SS TG M25



- EPIC® H-BE 10 screw-termination male insert
- With wire protection
- EPIC® H-B 10 hood

Article number	Pieces/PU
EPIC® H-BE 10 Kits	
75009640	1

Article numbers for single components

- EPIC® H-BE 10 SS 10192000
- H-B 10 TG M25 19040100



EPIC® KIT H-BE 10 SS TS M25



- EPIC® H-BE 10 screw-termination male insert
- With wire protection
- EPIC® H-B 10 hood

Article number	Pieces/PU
H-B 10 TG M25	
75009641	1

Article numbers for single components

- EPIC® H-BE 10 SS 10192000
- H-B 10 TS M25 19042100



EPIC KIT H-BE 10 BS AG



- EPIC® H-BE 10 screw-termination female insert
- With wire protection
- EPIC® H-B 10 panel-mount base

Article number	Pieces/PU
H-B 10 TS M25	
75009642	1

Article numbers for single components

- EPIC® H-BE 10 BS 10193000
- H-B 10 AG 10032000



EPIC KIT H-BE 10 BS SGR M25



- EPIC® H-BE 10 screw-termination female insert
- With wire protection
- EPIC® H-B 10 surface-mount base

Article number	Pieces/PU
H-B 10 AG	
75009643	1

Article numbers for single components

- EPIC® H-BE 10 BS 10193000
- H-B 10 SGR M25 19034100



EPIC® KIT H-BE 10 BS TBF M25



- EPIC® H-BE 10 screw-termination female insert
- With wire protection
- EPIC® H-B 10 cable coupler hood

Article number	Pieces/PU
H-B 10 SGR M25	
75009644	1

Article numbers for single components

- EPIC® H-BE 10 BS 10193000
- H-B 10 TBF M25 79040200





EPIC® H-BE 16 Kits

Benefits

- Pre-packed kits with compatible components
- Uncomplicated ordering
- No misplaced orders

Technical data

	Rated voltage (V) IEC: 500 V UL: 600 V CSA: 600 V
	Rated current (A) IEC: 16 A UL: 16 A CSA: 16 A
	Number of contacts 16 + PE

Info

- Complete connectors – easy to order starting from 1 piece

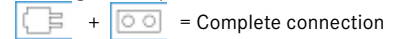

Article number	Pieces/PU
EPIC® H-BE 16 Kits	
75009645	1

Article numbers for single components

- EPIC® H-BE 16 SS 10194000
- H-B 16 TG M25 19080000

EPIC® KIT H-BE 16 SS TG M25



- EPIC® H-BE 16 screw-termination female insert
- With wire protection
- EPIC® H-B 16 hood



Article number	Pieces/PU
H-B 16 TG M25	
75009646	1

Article numbers for single components

- EPIC® H-BE 16 SS 10194000
- H-B 16 TS M25 19082000

EPIC® KIT H-BE 16 SS TS M25



- EPIC® H-BE 16 screw-termination female insert
- With wire protection
- EPIC® H-B 16 hood



Article number	Pieces/PU
H-B 16 TS M25	
75009647	1

Article numbers for single components

- EPIC® H-BE 16 BS 10195000
- H-B 16 AG 10072000

EPIC® KIT H-BE 16 BS AG



- EPIC® H-BE 16 screw termination female insert
- With wire protection
- EPIC® H-B 16 panel-mount base



Article number	Pieces/PU
H-B 16 AG	
75009648	1

Article numbers for single components

- EPIC® H-BE 16 BS 10195000
- H-B 16 SGR M25 19074000

EPIC® KIT H-BE 16 BS SGR M25



- EPIC® H-BE 16 screw termination female insert
- With wire protection
- EPIC® H-B 16 surface-mount base



Article number	Pieces/PU
H-B 16 SGR M25	
75009649	1

Article numbers for single components

- EPIC® H-BE 16 BS 10195000
- H-B 16 TBF M25 19086000

EPIC® KIT H-BE 16 BS TBF M25



- EPIC® H-BE 16 screw termination female insert
- With wire protection
- EPIC® H-B 16 cable coupler hood



EPIC® H-BE 24 Kits

Benefits

- Pre-packed kits with compatible components
- Uncomplicated ordering
- No misplaced orders

Technical data

	Rated voltage (V) IEC: 500 V UL: 600 V CSA: 600 V
	Rated current (A) IEC: 16 A UL: 16 A CSA: 16 A
	Number of contacts 24 + PE

Info

- Complete connectors – easy to order starting from 1 piece

+ = Complete connection

EPIC® KIT H-BE 24 SS TG M25



- EPIC® H-BE 24 screw-termination male insert
- With wire protection
- EPIC® H-B 24 hood

Article number	Pieces/PU
EPIC® H-BE 24 Kits	
75009650	1
Article numbers for single components	
• EPIC® H-BE 24 SS 10196000	
• H-B 24 TG M25 19121000	



EPIC® KIT H-BE 24 SS TS M25



- EPIC® H-BE 24 screw-termination male insert
- With wire protection
- EPIC® H-B 24 hood

Article number	Pieces/PU
H-B 24 TG M25	
75009651	1
Article numbers for single components	
• EPIC® H-BE 24 SS 10196000	
• H-B 24 TS M25 19113000	



EPIC® KIT H-BE 24 BS AG



- EPIC® H-BE 24 screw-termination female insert
- With wire protection
- EPIC® H-B 24 panel-mount base

Article number	Pieces/PU
H-B 24 TS M25	
75009652	1
Article numbers for single components	
• EPIC® H-BE 24 BS 10197000	
• H-B 24 AG 10102000	



EPIC® KIT H-BE 24 BS SGR M25



- EPIC® H-BE 24 screw-termination female insert
- With wire protection
- EPIC® H-B 24 surface-mount base

Article number	Pieces/PU
H-B 24 AG	
75009653	1
Article numbers for single components	
• EPIC® H-BE 24 BS 10197000	
• H-B 24 SGR M25 19104000	



EPIC® KIT H-BE 24 BS TBF M25



- EPIC® H-BE 24 screw-termination female insert
- With wire protection
- EPIC® H-B 24 cable coupler hood

Article number	Pieces/PU
H-B 24 SGR M25	
75009654	1
Article numbers for single components	
• EPIC® H-BE 24 BS 10197000	
• H-B 24 TBF M25 19127000	





EPIC® SIGNAL M23 Kits 12pole

Benefits

- Uncomplicated ordering
- No misplaced orders
- Pre-packed kits with compatible components

Technical data

	Rated voltage (V) 100 V (1 mm contacts)
	Rated current (A) 7 A (1 mm contacts)
	Number of contacts 12

Info

- Complete connectors - easy to order starting from 1 piece

+ = Complete connection



Article number	Pieces/PU
EPIC® SIGNAL M23 Kits 12pole	
75009710	1

Article numbers for single components

- E-Part 73002722
- M23 D6 44420037

EPIC® KIT M23 D6 12-POL FEMALE



- EPIC® M23 12-pin solder termination female insert
- Max. cross-section 1.0 mm²
- E-Part, rotation to the right, clockwise
- D6 cable connector, clamping range 7.0 – 13.5 mm



Article number	Pieces/PU
M23 A1	
75009711	1

Article numbers for single components

- P-part 73002714
- M23 A1 72004000

EPIC® KIT M23 A1 12-POL MALE



- EPIC® M23 12-pin solder-termination male insert
- Max. cross-section 1.0 mm²
- P-part, rotation to the left, anticlockwise
- A1 panel-mount box, front wall mounting



Article number	Pieces/PU
M23 A3	
75009712	1

Article numbers for single components

- P-part 73002714
- M23 A3 24420055

EPIC® KIT M23 A3 12-POL MALE



- EPIC® M23 12-pin solder-termination male insert
- Max. cross-section 1.0 mm²
- P-part, rotation to the left, anticlockwise
- A3 panel-mount box, angled and rotatable, front wall mounting



Article number	Pieces/PU
M23 F6	
75009713	1

Article numbers for single components

- P-part 73002714
- M23 F6 44420040

EPIC® KIT M23 F6 12-POL MALE



- EPIC® M23 12-pin solder-termination male insert
- Max. cross-section 1.0 mm²
- P-part, rotation to the left, anticlockwise
- F6 cable coupler, clamping range 7.0 – 13.5 mm



EPIC® SIGNAL M23 Kits 12pole

Benefits

- Uncomplicated ordering
- No misplaced orders
- Pre-packed kits with compatible components

Technical data

	Rated voltage (V) 100 V (1 mm contacts)
	Rated current (A) 7 A (1 mm contacts)
	Number of contacts 12

Info

- Complete connectors - easy to order starting from 1 piece

+ = Complete connection

EPIC® KIT M23 D6 12-POL FEMALE



- EPIC® M23 12-pin solder termination female insert
- Max. cross-section 1.0 mm²
- P-part, rotation to the left, anticlockwise
- D6 cable connector, clamping range 7.0 - 13.5 mm

Article number	Pieces/PU
M23 D6	
75009702	1
Article numbers for single components	
• P-part 73002716	
• M23 D6 44420037	



EPIC® KIT M23 A1 12-POL MALE



- EPIC® M23 12-pin solder-termination male insert
- Max. cross-section 1.0 mm²
- E-Part, rotation to the right, clockwise
- A1 panel-mount box, front wall mounting

Article number	Pieces/PU
M23 A1	
75009703	1
Article numbers for single components	
• E-Part 73002720	
• M23 A1 72004000	



EPIC® KIT M23 A3 12-POL MALE



- EPIC® M23 12-pin solder-termination male insert
- Max. cross-section 1.0 mm²
- E-Part, rotation to the right, clockwise
- A3 panel-mount box, angled and rotatable, front wall mounting

Article number	Pieces/PU
M23 A3	
25009704	1
Article numbers for single components	
• E-Part 73002720	
• M23 A3 24420055	



EPIC® KIT M23 F6 12-POL MALE



- EPIC® M23 12-pin solder-termination male insert
- Max. cross-section 1.0 mm²
- E-Part, rotation to the right, clockwise
- F6 cable coupler, clamping range 7.0 - 13.5 mm

Article number	Pieces/PU
M23 F6	
75009705	1
Article numbers for single components	
• E-Part 73002720	
• M23 F6 44420040	





EPIC® SIGNAL M23 Kits 17pole

Benefits

- Uncomplicated ordering
- No misplaced orders
- Pre-packed kits with compatible components

Technical data

	Rated voltage (V) 50 V (1 mm contacts)
	Rated current (A) 7 A (1 mm contacts)
	Number of contacts 17

Info

- Complete connectors - easy to order starting from 1 piece

= Complete connection



Article number	Pieces/PU
EPIC® SIGNAL M23 Kits 17pol.	
75009706	1

Article numbers for single components

- P-part 73018000
- M23 D6 44420037

EPIC KIT M23 D6 17-POL FEMALE



- EPIC® M23 17-pin solder termination female insert
- Max. cross-section 1.0 mm²
- P-part, rotation to the left, anticlockwise
- D6 cable connector, clamping range 7.0 – 13.5 mm



Article number	Pieces/PU
M23 D6	
75009707	1

Article numbers for single components

- E-Part 73028500
- M23 A1 72004000

EPIC KIT M23 A1 17-POL MALE



- EPIC® M23 17-pin solder-termination male insert
- Max. cross-section 1.0 mm²
- E-Part, rotation to the right, clockwise
- A1 panel-mount box, front wall mounting



Article number	Pieces/PU
M23 A1	
25009708	1

Article numbers for single components

- E-Part 73028500
- M23 A3 24420055

EPIC KIT M23 A3 17-POL MALE



- EPIC® M23 17-pin solder-termination male insert
- Max. cross-section 1.0 mm²
- E-Part, rotation to the right, clockwise
- A3 panel-mount box, angled and rotatable, front wall mounting



Article number	Pieces/PU
M23 A3	
75009709	1

Article numbers for single components

- E-Part 73028500
- M23 F6 44420040

EPIC KIT M23 F6 17-POL MALE



- EPIC® M23 17-pin solder-termination male insert
- Max. cross-section 1.0 mm²
- E-Part, rotation to the right, clockwise
- F6 cable coupler, clamping range 7.0 – 13.5 mm



EPIC® LS1 Kits 6pole

Benefits

- Pre-packed kits with compatible components
- Uncomplicated ordering
- No misplaced orders

Technical data

- Rated voltage (V)**
630 V (2 mm contacts)
- Rated current (A)**
26 A/3 + PE + 4, 25 A/5 + PE
(2 mm contacts)
- Number of contacts**
5 + PE

Info

- Complete connectors - easy to order starting from 1 piece

+ = Complete connection

EPIC KIT LS1 D6 6-POL FEMALE



- Pin configuration 5+PE, for female contacts 2 mm \varnothing
- Machined crimp contacts 0.5 - 2.5 mm² are included
- D6 cable connector, clamping range 7.5 - 15.5 mm

Article number	Pieces/PU
EPIC® LS1 Kits 6pole	
75009690	1
Article numbers for single components	
• LS1 D6 76123000	



EPIC KIT LS1 A1 6-POL MALE



- Pin configuration 5+PE, for male contacts 2 mm \varnothing
- Machined crimp contacts 0.5 - 2.5 mm² are included
- A1 panel-mount box, front wall mounting

Article number	Pieces/PU
LS1 D6	
75009691	1
Article numbers for single components	
• LS1 A1 76003000	



EPIC KIT LS1 A3 6-POL MALE



- Pin configuration 5+PE, for male contacts 2 mm \varnothing
- Machined crimp contacts 0.5 - 2.5 mm² are included
- A3 panel-mount box, angled and rotatable, front wall mounting

Article number	Pieces/PU
LS1 A1	
75009692	1
Article numbers for single components	
• LS1 A3 24420058	



EPIC KIT LS1 F6 6-POL MALE



- Pin configuration 5+PE, for male contacts 2 mm \varnothing
- Machined crimp contacts 0.5 - 2.5 mm² are included
- F6 cable coupler, clamping range 7.5 - 15.5 mm

Article number	Pieces/PU
LS1 A3	
75009693	1
Article numbers for single components	
• LS1 F6 76133000	





EPIC® LS1 Kits 8pole

Benefits

- Uncomplicated ordering
- No misplaced orders
- Pre-packed kits with compatible components

Technical data

	Rated voltage (V) 630 V (2 mm contacts) 250 V (1 mm contacts)
	Rated current (A) 26 A/3 + PE + 4, 25 A/5 + PE (2 mm contacts) 7 A (1 mm contacts)
	Number of contacts 3 + PE + 4

Info

- Complete connectors - easy to order starting from 1 piece

+ = Complete connection



Article number	Pieces/PU
EPIC® LS1 Kits 8pole	
75009694	1

Article numbers for single components

- LS1 D6 76124000

EPIC KIT LS1 D6 8-POL FEMALE



- Pin configuration 3 + PE + 4, for female contacts 2 mm ϕ + 1 mm ϕ
- Machined crimp contacts 0.5 – 2.5 mm² and 0.14 – 1.0 mm² are included
- D6 cable connector, clamping range 7.5 – 15.5 mm



Article number	Pieces/PU
LS1 D6	
75009695	1

Article numbers for single components

- LS1 A1 76004000

EPIC KIT LS1 A1 8-POL MALE



- Pin configuration 3 + PE + 4, for male contacts 2 mm ϕ + 1 mm ϕ
- Machined crimp contacts 0.5 – 2.5 mm² and 0.14 – 1.0 mm² are included
- A1 panel-mount box, front wall mounting



Article number	Pieces/PU
LS1 A1	
75009696	1

Article numbers for single components

- LS1 A3 24420056

EPIC KIT LS1 A3 8-POL MALE



- Pin configuration 3 + PE + 4, for male contacts 2 mm ϕ + 1 mm ϕ
- Machined crimp contacts 0.5 – 2.5 mm² and 0.14 – 1.0 mm² are included
- A3 panel-mount box, angled and rotatable, front wall mounting



Article number	Pieces/PU
LS1 A3	
75009697	1

Article numbers for single components

- LS1 F6 76134000

EPIC KIT LS1 F6 8-POL MALE



- Pin configuration 3 + PE + 4, for male contacts 2 mm ϕ + 1 mm ϕ
- Machined crimp contacts 0.5 – 2.5 mm² and 0.14 – 1.0 mm² are included
- F6 cable coupler, clamping range 7.5 – 15.5 mm



EPIC® SOLAR 4 M

Info

- 4 mm connector system with double hook
- Field-mountable solar connector

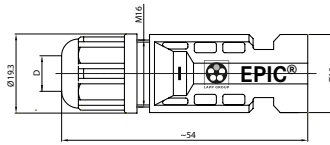

EPIC® SOLAR 4 F

Info

- 4 mm connector system with double hook
- Field-mountable solar connector

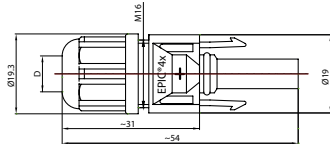

Benefits

- Low contact-resistance for efficient power transmission
- Crimp connection for field mounting
- Suitable for various ÖLFLEX® SOLAR cables

Application range

- Photovoltaic plants
- Crystalline and thin-film constructions
- Solartracker

Product features

- 4 mm connector system with double hook
- TÜV Rheinland certified
- Inclusive contacts

Suitable cables

- ÖLFLEX® SOLAR XLR-R
- ÖLFLEX® SOLAR XLR WP
- ÖLFLEX® SOLAR XLS-R
- ÖLFLEX® SOLAR XLR 1,5kV
- ÖLFLEX® SOLAR XLR 1,5kV WP
- ÖLFLEX® SOLAR XLC

Suitable tools

- EPIC® SOLAR TOOL
- For easier assembly of the plastic parts, use EPIC® SOLAR 4 Assembly Tool Set (2 pieces). Holder for insulation body, spanner for cap nut and pins for unlocking

Suitable connectors

- EPIC® SOLAR 4 THIN
- EPIC® SOLAR 4 M
- EPIC® SOLAR 4Plus F

Technical data

ETIM 5.0 Class-ID: EC002641
 ETIM 5.0 Class-Description: Modular connector (industrial connector)

Rated voltage (V)
 1000 V AC/DC

Rated impulse voltage
 8 kV

Degree of soiling
 3

Contact resistance
 < 0.5 mOhm

Protection rating
 IP 67

Protection class
 II

Temperature range
 -40°C ... +105°C

Article number	Article designation	Cross-section (mm ²)	Clamping range in mm	Rated current (A)	PU
EPIC® SOLAR 4 male field-mountable, inclusive contacts					
M4428200	EPIC® SOLAR 4 M 2.5 mm ²	2.5	4.8 - 6.0	22	1
M4428201	EPIC® SOLAR 4 M 4 mm ² ... 6 mm ²	4 - 6	5.2 - 7.1	30	1
EPIC® SOLAR 4 female field-mountable, inclusive contacts					
M4428203	EPIC® SOLAR 4 F 2.5 mm ²	2.5	5.2 - 6.5	22	1
M4428204	EPIC® SOLAR 4 F 4 mm ² ... 6 mm ²	4 - 6	5.0 - 7.2	30	1
EPIC® SOLAR 4 assembly tool					
44428224	EPIC® SOLAR 4 Assembly Tool Set				1

Photographs are not to scale and do not represent detailed images of the respective products.

Table 31-1: EPIC® rectangular connectors

1. Cable Gland:
 The Cable Gland provides a seal between the cable and the connector housing. It may also be used to offer additional functions like strain relief and braid continuity for EMC protection.

2. Upper housing:
 Hood

3. Male insert:
 Types of contact termination
 • Screw
 • Crimp*
 • Cage clamp
 • Push-In

4. Female insert:
 Types of contact termination
 • Screw
 • Crimp*
 • Cage clamp
 • Push-In

5. Lower housing:
 • Panel mounting (cable entry through cut out in panel)
 • Surface mounting (cable entry through a gland into the side of the connector base)
 • Cable Connector Hood, cable to cable connection

* contacts must be ordered separately

Please pay attention on the EPIC® Selection table A10, this table is a great guide in helping you to find the right insert and suitable housings. It is particularly convenient using the connector with the connectorfinder in the internet (www.lappgroup.com/connectorfinder) and the connector housing configurator for customized solutions (www.lappgroup.com/connector-housing). You will also find configured connector kits in our webcatalogue.

High variety of applications with EPIC® rectangular connectors:

- Number of pins from 1 up to 216
- Currents up to 220A
- Voltage up to 1.000V
- Modular system with inserts for power supply, signal and data transmission, fiber optics, coax connection and compressed air
- Termination technologies: Screw, crimp, cage clamp, solder, Push-In
- Housings for cable connection and for the assembly on devices
- **Degree of protection** (depends on the type of housing and the cable gland. Therefore we recommend to use a brass gland with integrated sealing ring for example SKINTOP® MS-M.)
- **EMC protection** (For applications with EMC requirements, we recommend the EPIC® ULTRA in combination with the SKINTOP® BRUSH.)

TIP: Only use tools recommended and approved by LAPP. This ensures the safe and long-term operation of the connector. An assurance of the technical characteristics, as well as the validity of the certificates can only be given if all components are used exclusively by LAPP.

WARNING: EPIC® industrial connectors may not be connected or disconnected under load.

Table 31-2: EPIC® housings and inserts

Hood (fig. 1):

It may have a top or angle (side) entry of different PG sizes to accommodate a wide range of cable diameters. The hood can be mated with either a surface or panel mounting base, or a cable coupler hood (for cable to cable connection).

Panel mount base (fig. 2):

It is wired from below through a hole cut in a panel. The panel base is attached to the surface of a control panel for connection of control or power cables.

Surface mount base (fig. 3):

The surface base is a complete enclosure only offering cable entry through a cable gland mounted either on one or both sides of the base.

Cable Coupler (fig. 4):

The cable connector hood mates with a top entry hood to offer cable to cable connection. This is frequently used to extend cables.

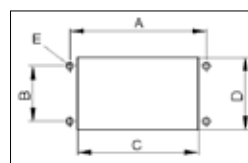

Panel cut out for panel mount base (mm)					
Panel mount base	A	B	C	D	E
H-A 3	30	—	21	21	3.3
H-A 10	70	17.5	57.5	24	3.6
H-A 16	86	17.5	73.7	24	3.6
H-A 32	92	42	74.2	48.4	4.3
H-A 48	110	65	85.5	71	5.5
H-B 6	70	32	52.2	35	4.3
H-B 10	83	32	65.2	35	4.3
H-B 16	103	32	85.5	35	4.3
H-B 24	130	32	112.2	35	4.3
H-B 32	110	65	85.5	71	5.5
H-B 48	148	70	117	82	7

Screw connection technology (as DIN EN 60999)				
Screw thread	M3	M4	M5	M6
Starting torque Nm	0.5	1.2	2.0	2.5
Clamping screw: H-A, H-BE, H-BVE	•			
Clamping screw: H-BS		•		
Grounding screw: H-A, H-BE, H-BVE		•		
Grounding screw: H-BS			•	
Clamping screw: Module High-Current				•
Fixing screw: Inserts and Module frames	•			

All EPIC® connectors refer to IEC 61984.

Reach us around the world

...or closer to home. To contact your local LAPP representative:

PLEASE VISIT

www.lappgroup.com/worldwide

Enter the world
of LAPP:



Our apps are available from
the following stores:



Image source: LAPP, Maiwolf, Wolfram Scheible, Bystronic glass, Comau SpA, EMAG, Fotolia, iStock

The following applies for the use of our products

The conformity of our products to the relevant European directives and compliance with the provisions contained therein shall be indicated by the CE marking.

The safety of our products is closely associated with how they are used. A knowledge of and adherence to the respective international/national standards of use (e.g. DIN VDE 0100; 0298) are

mandatory. There are particular risks if installed improperly. This applies to all our products/items:

Processing is only to be done by an authorised electrician! Otherwise, there is the risk of an electric shock or a fire ignited by electric current!

Safety

Without exception, our products are tested for application safety in accordance with defined standards and our own regulations, which complement the standards. Relevant legal requirements and safety regulations are also observed. Provided due care and attention is paid, the possibility of product-specific danger to the user may thus reasonably be excluded. Where products are used carelessly or incorrectly, however, considerable danger to persons and the environment may arise. For this reason, our

cables must only be processed and/or used responsibly by trained electricians or specialists. This catalogue contains general information for the application of each product. Independent of such information, the application standards DIN VDE 0298 and DIN VDE 0891 for cables will apply. Excerpts from these standards, as well as complementary selection and application tables, design and installation guidelines, are contained in the tables in the appendix to this catalogue. Our machines and installation tools

are – where necessary – designed in accordance with the machine guidelines and display the CE identification mark. It must be noted, however, that our machines and installation tools must only be used by trained specialist personnel and for the purpose for which they were designed.

©Copyright by U.I. Lapp GmbH.

Reprinting or reproduction of the text or the illustrations may be made only with written approval and with correct indication of source. We reserve the right to make modifications to our products, especially those based on technical improvements or continued development. All illustrations and numerical data etc. are therefore without warranty and are subject to change.



ÖLFLEX®
Power and control cables



UNITRONIC®
Data communication systems



ETHERLINE®
Data communication systems
for ETHERNET technology



HITRONIC®
Optical transmission systems



EPIC®
Industrial connectors



SKINTOP®
Cable glands



SILVYN®
Protective cable conduit systems
and cable carrier systems



FLEXIMARK®
Marking systems

Follow LAPP on



Terms of Trade:

Our general conditions of sale
can be downloaded from our website
www.lappgroup.com/terms



www.lappgroup.com

To contact your local LAPP representative,
please visit www.lappgroup.com/worldwide